



CLASS 600 CAST STEEL BALL VALVE

FIG.# 4E-46WCB16LHF-2F (A182 F316 Ball)

or

FIG.# 4E-46WCB05LHF-2F (A105+ENP Ball)

Sizes: 2" – 4" @ ANSI 600

Designed and Manufactured to API 6D Manufacturing Standard: ASME B16.34
 2- PC Body Design, Floating Ball Face to Face: ANSI B16.10
 API 607 Fire Safe Designed End Flanges: ANSI B16.5
 NACE MR- 0175 Compliance ISO Mounting Pad: ISO 5211
 Full Port, Raised Face and RTJ

CLASS	Pressure Test (MPa)		
	Shell Test	Seat Test	Air Test
600 LB	15.0	11.0	0.6
Applicable Temperature	- 29°C (- 20°F) ~ 100°C (212°F)		
Applicable Media	W.O.G.		

MATERIAL LIST		
No.	Part Name	Material
1.	Body	ASTM A216 WCB
2.	Stud Bolts	ASTM A193 B7M
3.	Nut	ASTM A194 2HM
4.	Bonnet	ASTM A216 WCB
5.	Middle Gasket	Graphite + SS316
6.	O- Ring	HNBR - 90
7.	Seat Ring	Devlon
8.	Rivets	SS
9.	Name Plate	SS
10.	Ball	ASTM A182 F316 or ASTM A105+ENP(75µm)
11.	Stem	ASTM A182 F316
12.	Thrust Bearing	PTFE
13.	O - Ring	HNBR - 90
14.	Anti Static Spring	SS
15.	Anti Static Ball	SS
17.	Grease Zerk	SS
18.	Handle Screw	ASTM A193 B7M
19.	Positioning Plate	SS
20.	Lever	ASTM A216 WCB + Zn
21.	Snap Ring	65Mn
22.	Stop Screw	ASTM A193 B7M

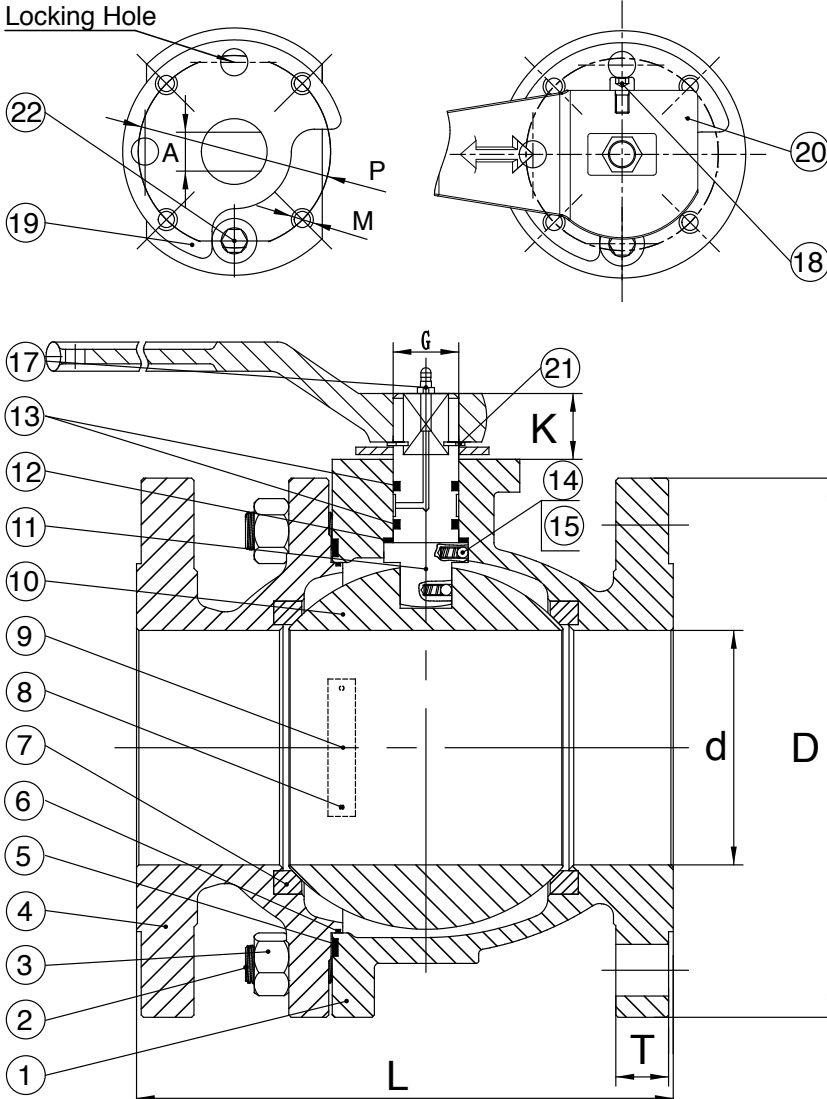

NOTE: 1. Please specify the material of Ball, Body Gasket, Seat and Packing when placing your order, otherwise 4E will ship out products in accordance with our inventory.
 2. Due to continuous development of our products, all products, specifications and data are subject to change without prior notice or obligation.

DIMENSIONS & WEIGHT				
SIZE	unit	2"	3"	4"
d	inch	1.93	2.99	3.94
	mm	49	76	100
L	inch	11.50	14.02	17.01
	mm	292	356	432
D	inch	6.50	8.27	10.83
	mm	165	210	275
T	inch	1.00	1.25	1.50
	mm	25.4	31.8	38.1
A	inch	0.55	0.87	0.94
	mm	14	22	24
G	inch	0.87	1.24	1.38
	mm	22	31.5	35
P	inch	1.97	4.02	4.02
	mm	50	102	102
M		1/4- 20	3/8- 16	3/8- 16
K	inch	0.98	1.34	1.57
	mm	25	34	40
Weight	lbs.	42.99	121.25	156.53
	kgs.	19.50	55.00	71.00
Torque	N·m	170	350	550