



2000PSI 1PC RP FORGED STEEL BALL VALVE

FIG.# 4E-420FGO16RRT-1R

Sizes: 1/4" - 2" @2,000 PSI NSCWP

Forged Steel Body, Blowout proof stem
 NPT end connections, Locking Handle, 1-Piece Body (Uni-
 body), Reduced Port, Nace
 NPT Threads Conforms to ANSI B1.20.1

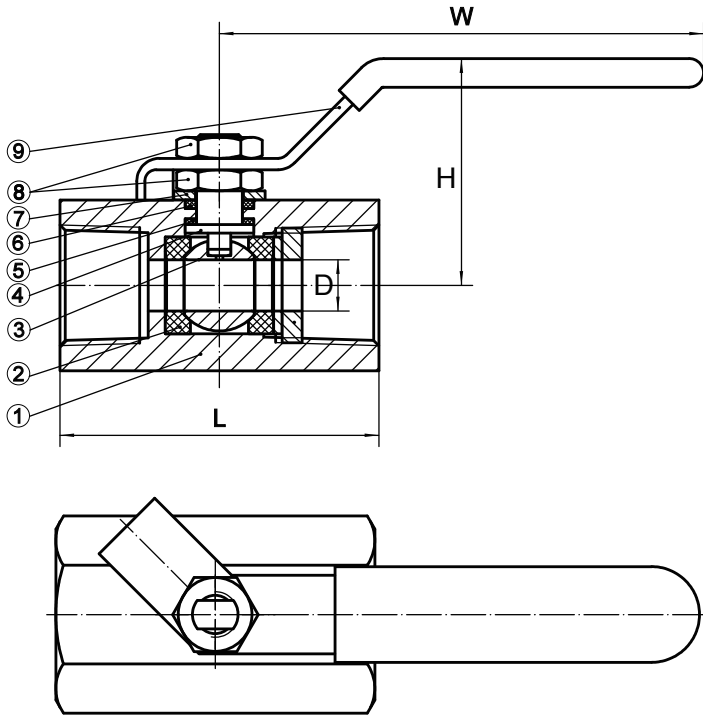

MATERIAL LIST		
No.	Part Name	Material
1.	Body	A105
2.	Seat	RPTFE
3.	Ball	SS 316
4.	Stem	SS 316
5.	Thrust Washer	RPTFE
6.	Packing	RPTFE
7.	Gasket	SS
8.	Hex Nut	SS
9.	Handle	SS
10.	End Cap	A105

Pressure Temperature Rating

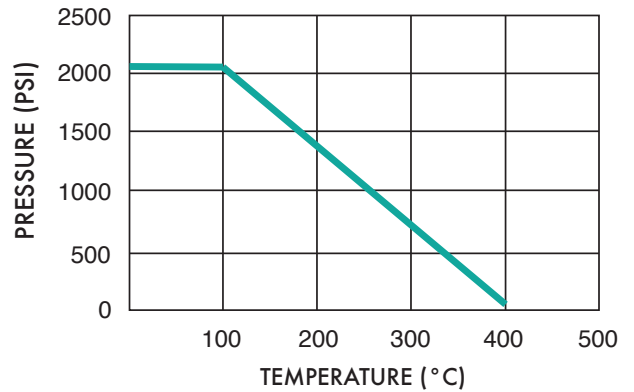

Weights are approximate and construction is subject to change without notice.

DIMENSIONS

SIZE	unit	1/4"	3/8"	1/2"	3/4"	1"	1-1/4"	1-1/2"	2"
D	mm	5.1	7.1	9.1	12.4	15.0	20.1	24.9	32.0
	inch	0.20	0.28	0.36	0.49	0.59	0.79	0.98	1.26
L	mm	42.9	47.0	63.0	70.1	86.1	94.0	102.1	113.0
	inch	1.69	1.85	2.48	2.76	3.39	3.70	4.02	4.45
H	mm	34.0	34.0	42.9	43.9	59.9	64.0	68.0	79.0
	inch	1.34	1.34	1.69	1.73	2.36	2.52	2.68	3.11
W	mm	84.1	84.1	93.0	100.1	119.9	134.9	152.1	169.9
	inch	3.31	3.31	3.66	3.94	4.72	5.31	5.99	6.69
Weight	kg.	0.12	0.17	0.31	0.48	0.94	1.37	1.70	2.90
	lbs.	0.265	0.374	0.683	1.058	2.072	3.02	3.748	6.393
Torque	N-m	2.00	3.00	6.00	8.00	12.00	16.00	20.00	30.00

