



200 PSI WAFER STYLE BUTTERFLY VALVE, Page 1/2

FIG.# 4E-A200-B (Buna Seat); 4E-A200-V (Viton Seat);

Pressure: 200 psi; ANSI Class 125/150 Capable;

Stocking Sizes: 2" - 12"

Back Order Sizes: 14" - 36"

Features

- Long neck; Pinless Disk; Alignment Holes;
- Ductile Iron body with Epoxy Coating;
- Seat material available in Buna, Viton or EPDM;
- Double D Shaft Stem Style;
- Operational Style: Lever and Gear Operator (12" and up)

Testing Pressure	Hydrostatic	Shell	Seal
		2" - 12": 300 psi	2" - 12": 220 psi
		14" - 24": 225 psi	14" - 24": 165 psi
		30" - 36": 150 psi	30" - 36": 110 psi
Standard	Inspection & Test	API 598	
	End Standard	ANSI B16.5 CL150	
	Design	API 609	

MATERIAL LIST		
No.	Part Name	Material
1.	Body	Ductile Iron
2.	Disc	Ductile Iron (Nickel Plated) CF8M
3.	Seat	BUNA- N Viton
4.	Stem	Double D Style SS 410
5.	Bushing	PTFE
6.	O - Ring	BUNA- N Viton

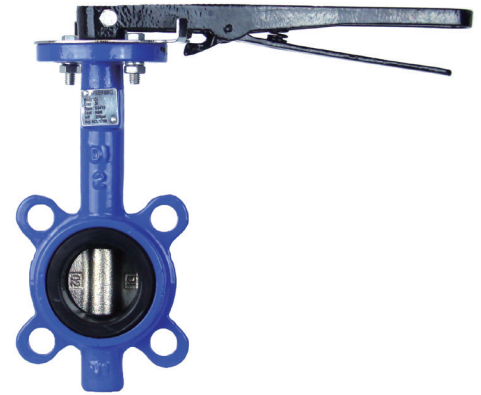

- NOTE:**
- Lever and Gear Operator must be specified at the point of order.
 - Due to the continuous development of our products, there may be short-term difference between our actual product specifications and the information shown on our cutsheet.

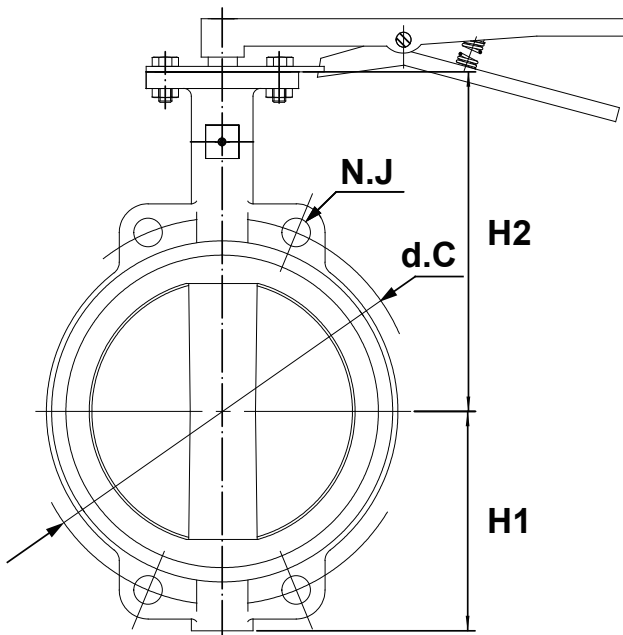

2" - 12"

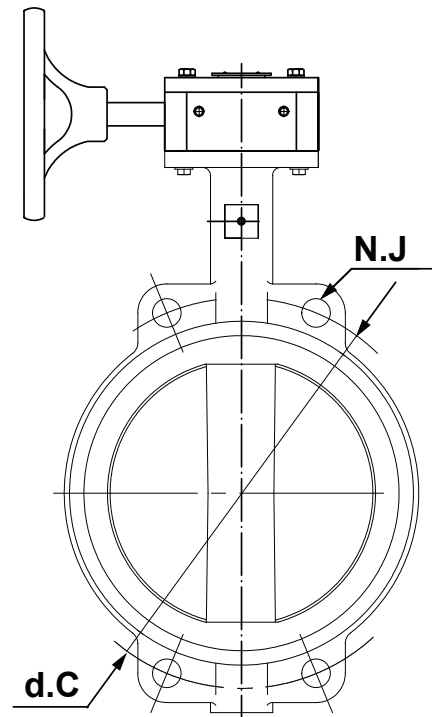

14"

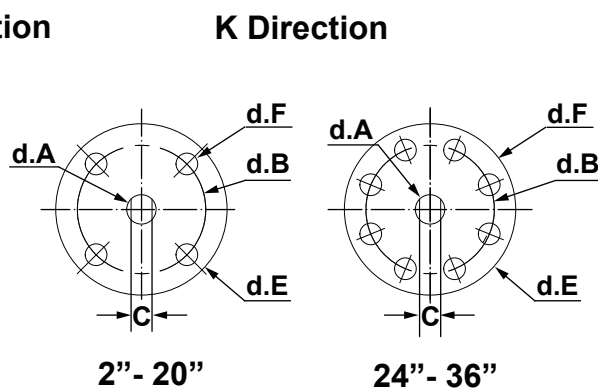
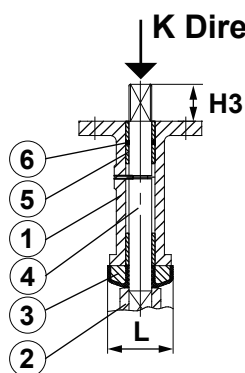
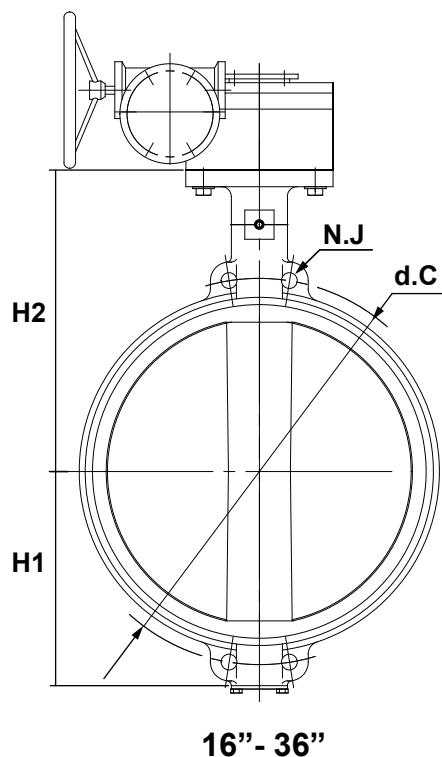

NOTE: 3. 'd.' is the abbreviation for diameter.
 4. Dimension 'N' is applicable to Lug Style Valves. Dimension 'M' is unified Inch Screw Thread, coarse pitch series (UNC) per ANSI B1.1.
 5. Dimensions and weights are for reference only. Weights 14" - 36" include gear operator.

DIMENSIONS & WEIGHT

SIZE	unit	2"	2-1/2"	3"	4"	5"	6"	8"	10"	12"	14"	16"	18"	20"	24"	30"	36"	
H1	inch	2.992	3.504	3.74	4.488	5	5.512	6.969	7.992	9.528	10.512	11.732	12.52	13.74	17.48	19.528	23.346	
	mm	76	89	95	114	127	140	177	203	242	267	298	318	349	444	496	593	
H2	inch	6.378	6.89	7.126	7.874	8.386	8.858	10.236	11.496	13.189	14.488	15.748	16.614	18.858	22.126	25.512	30.236	
	mm	162	175	181	200	213	225	260	292	335	368	400	422	479	562	648	768	
H3	inch	1.181	1.181	1.181	1.181	1.181	1.181	1.417	1.417	1.417	1.772	2.008	2.008	2.52	2.756	2.835	3.031	
	mm	30	30	30	30	30	30	36	36	36	45	51	51	64	70	72	77	
L	inch	1.811	1.929	1.929	2.165	2.303	2.323	2.52	2.815	3.189	3.13	3.543	4.291	5.315	6.181	6.811	8.307	
	mm	46	49	49	55	58.5	59	64	71.5	81	79.5	90	109	135	157	173	211	
d.A	inch	0.5	0.5	0.5	0.622	0.75	0.75	0.874	1.126	1.252	1.252	1.311	1.496	1.62	1.994	2.494	2.923	
	mm	12.7	12.7	12.7	15.8	19.05	19.05	22.2	28.6	31.8	31.8	33.3	38	41.15	50.65	63.35	74.25	
ANSI B16.5	d.C	inch	4.744	5.492	6.004	7.5	8.504	9.508	11.752	14.252	17.008	18.74	21.24	22.756	25	29.508	36.004	42.756
		mm	120.5	139.5	152.5	190.5	216	214.5	298.5	362	432	476	539.5	578	635	749.5	914.5	1086
	Qty.	4	4	4	8	8	8	8	12	12	12	16	16	20	20	28	32	
N.J	inch	0.748	0.748	0.748	0.748	0.866	0.866	0.866	0.984	0.984	1.142	1.142	1.26	1.26	1.378	1.378	1.614	
	mm	19	19	19	19	22	22	22	25	25	29	29	32	32	35	35	41	
d.E	inch	3.543	3.543	3.543	3.543	3.543	3.543	4.921	4.921	5.906	5.906	8.268	8.268	8.268	11.811	11.811	11.811	
	mm	90	90	90	90	90	90	125	125	150	150	210	210	210	300	300	300	
d.B	inch	2.756	2.756	2.756	2.756	2.756	2.756	4.016	4.016	4.921	4.921	6.496	6.496	6.496	10	10	10	
	mm	70	70	70	70	70	70	102	102	125	125	165	165	165	254	254	254	
d.F	inch	0.354	0.354	0.354	0.354	0.354	0.354	0.433	0.433	0.512	0.512	0.866	0.866	0.866	0.709	0.709	0.709	
	mm	9	9	9	9	9	9	11	11	13	13	22	22	22	18	18	18	
C	inch	0.394	0.394	0.394	0.472	0.551	0.551	0.669	0.866	0.945	0.945	1.063	1.063	1.26	1.417	1.752	2.047	
	mm	10	10	10	12	14	14	17	22	24	24	27	27	32	36	44.5	52	
Weight	lbs.	6.504	8.664	8.708	11.861	15.895	18.497	30.865	41.403	66.58	112.44	202.83	240.30	335.10	571	906.1	1036.2	
	kgs.	2.95	3.93	3.95	5.38	7.21	8.39	14	18.78	30.2	51	92	109	152	259	411	470	
Torque	N-m	20	28	38	71	115	170	330	510	660	820	1400	1200	2100	2800	3900	5800	